

# LW9 Sliding Door Lock



ASSA ABLOY

## Installation Instructions

Experience a safer  
and more open world

**Application:** Provides safe latching or secure deadlocking for sliding aluminium and timber doors.  
**Operation:** Snib to latch, key to deadlock.

- Tools Required:**
- Drill
  - Ø3mm Drill Bit
  - Phillips Screwdriver #2
  - Hacksaw or cutters
  - Ø10mm Drill Bit
  - Rule and pencil or marker

### LW9 Components

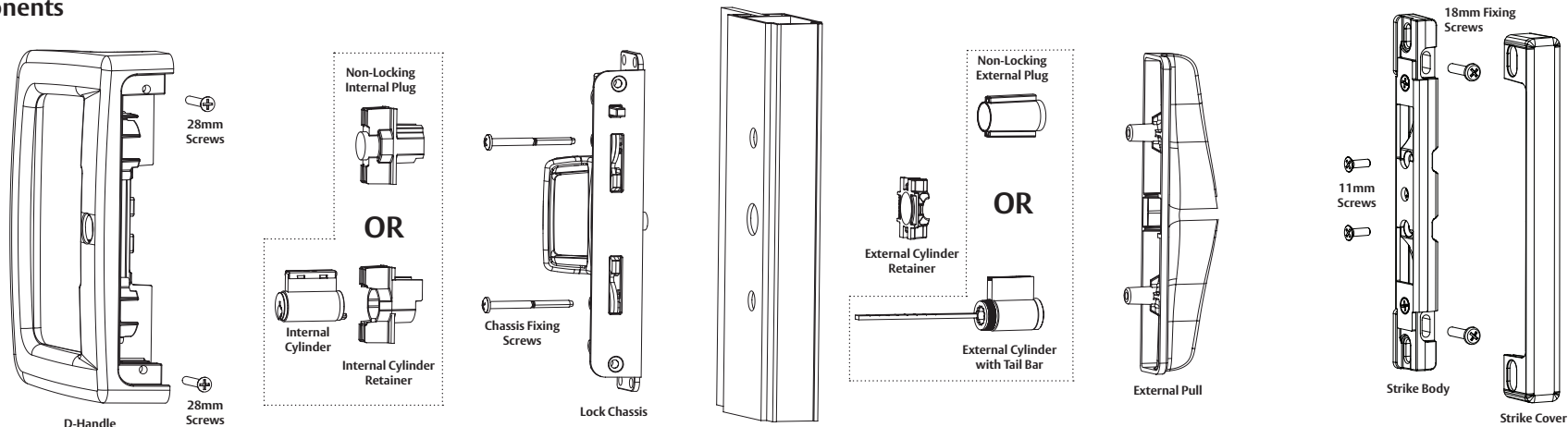

### 1. Door Preparation

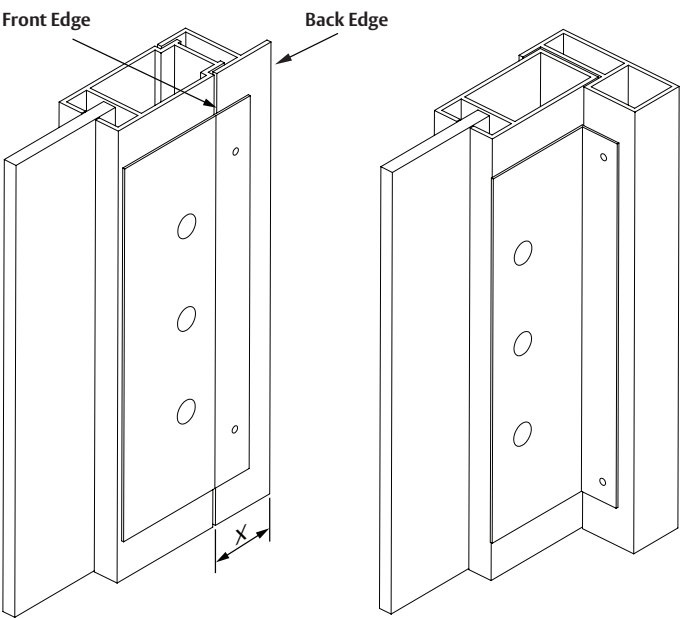

- Surface Fix (Follow holes labelled A)**
- Ensure door is closed correctly. Place template on the inside surface of the jamb (fixed door frame) at the desired height.
  - If 'X' is greater than 19mm, align 'LINE 1' with the front edge.
  - If 'X' is less than 19mm align 'LINE 2' against the back edge.
  - Mark and drill handle fixing holes labelled 'A' (3 x Ø10mm).
  - Mark and drill strike fixing holes labelled 'A' (2 x Ø3mm).
- Side Fix (Follow holes labelled B)**
- Fold template 90° along 'LINE 1'.
  - Ensure door is closed correctly. Place template against the door surface at the desired height.
  - Mark and drill handle fixing holes labelled 'B' (3 x Ø10mm).
  - Mark and drill strike fixing holes labelled 'B' (2 x Ø3mm).
- Note: Do not fold template over front edge step.

### 2. Lock Chassis Preparation

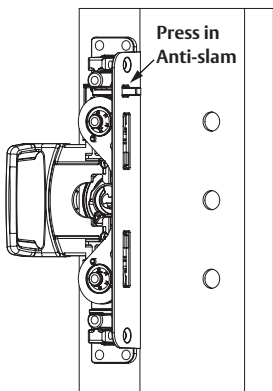

- Orientate the lock chassis so that the lock beaks face towards the door jamb.

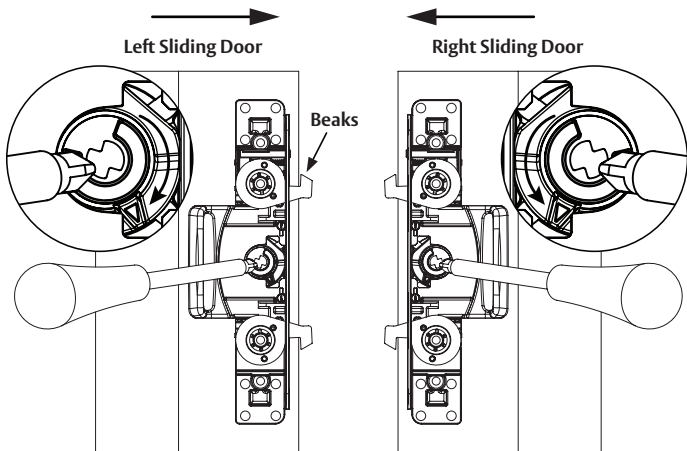

- To set the lock for right or left sliding door configuration, use a screw driver to rotate the Hub downward, to the corresponding position as shown.

### 3. External Pull Preparation

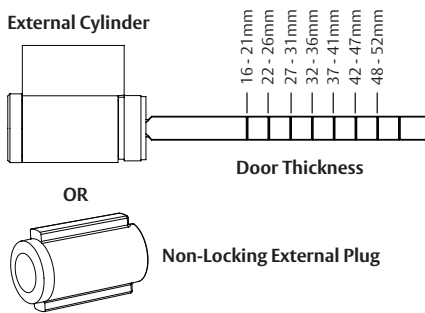

- For a non-locking external pull, use the external plug and retainer supplied
- For a locking external pull, trim the tail bar of the cylinder at the mark corresponding to the door thickness as shown using Hacksaw or cutter

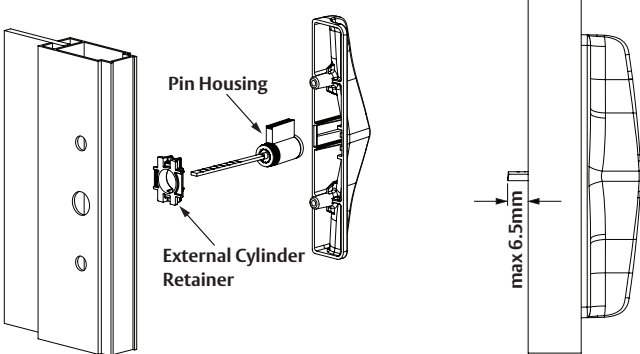

- Fit the plug with the cylinder with trimmed tail bar and orientate so that the pin housing points up with respect to the door.
- Push fit the cylinder retainer into the back of the pull.

Note: Allow an extra 5mm if a handle packer (purchased separately) is to be fitted

### 4. Screw Selection

- Several chassis fixing screws are provided to suit different door thicknesses.
- Use the table to identify which are the correct length fixing screws for your application.

Door Thickness

Screw Selection

19 - 28 mm

M4 x 45mm

29 - 38 mm

M4 x 55mm

39 - 45 mm

M4 x 65mm

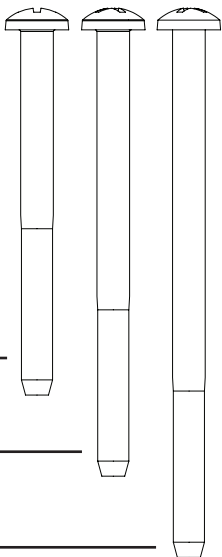

Template

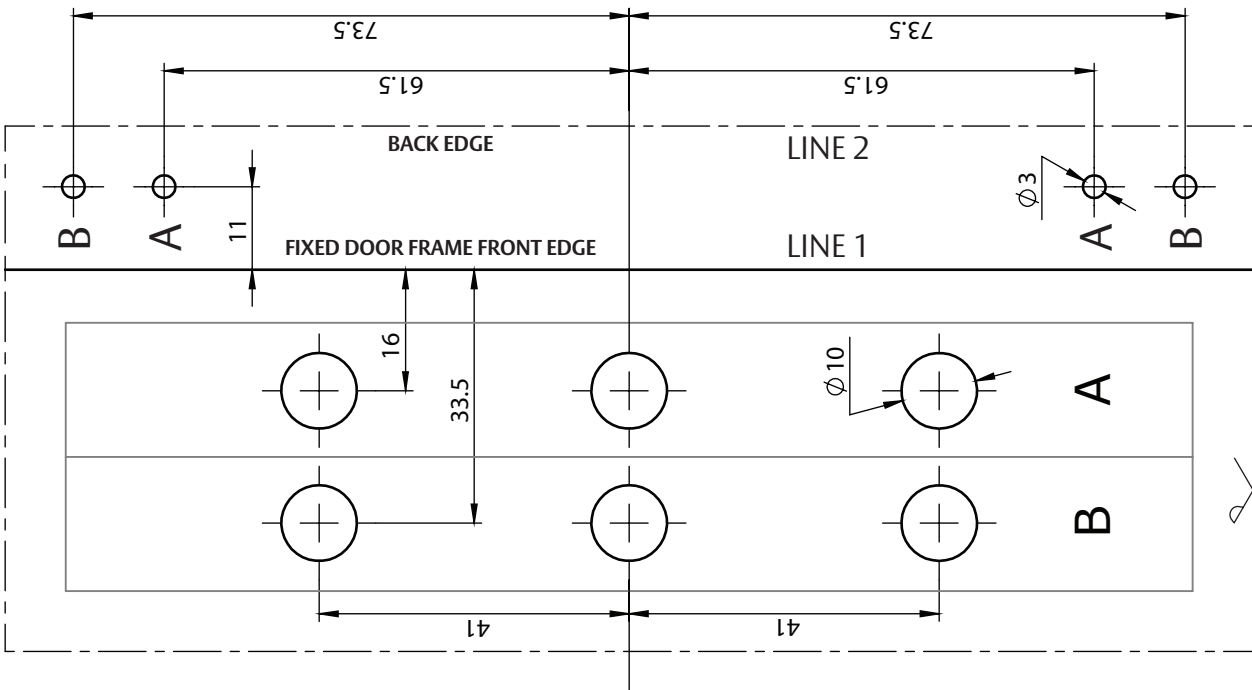

# LW9 Sliding Door Lock



ASSA ABLOY

## Installation Instructions

Experience a safer  
and more open world

### 5. Fixing Chassis & Pull To Door

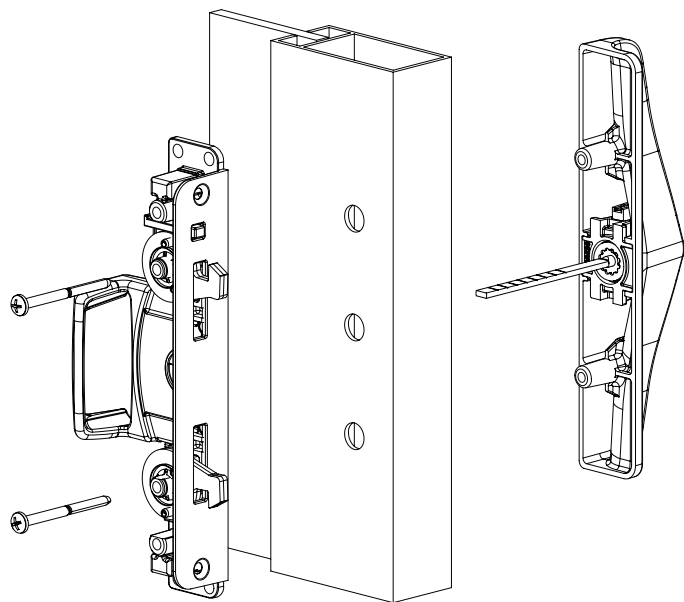

- Place the external pull on the external face of the door.
- Place the chassis on the internal face of the door.
- For exterior locking versions, align the tailbar into the lock chassis hub.
- Secure together with chassis fixing screws provided.

### 6. Fixing Internal D-Handle

- For locking version, fit the cylinder into the internal cylinder retainer.
- For non-locking, fit the internal non-locking plug orientated as shown below.

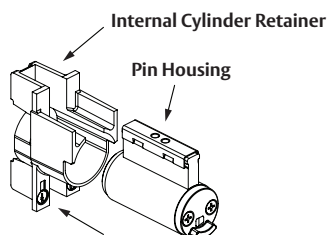

- For locking version, orientate the cylinder so that the pin housing points up with respect to the door.
- For non-locking version orientate the plug with the arrow point upwards with respect to the door. Firmly push the plug into the D-handle.

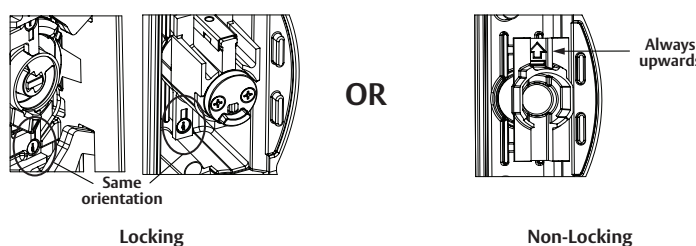
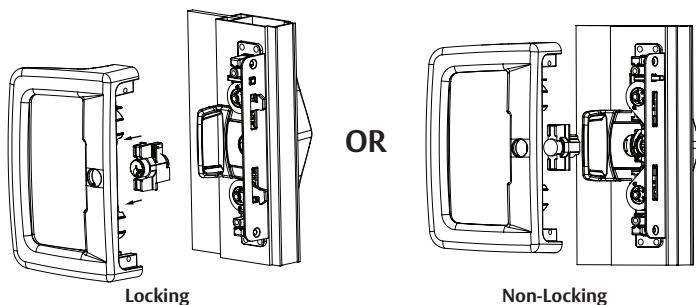

- Fix the D-handle to the lock chassis by screwing the 2x28mm screws into the side.



### 7. Strike Installation

#### Surface Fix

- Fix the strike body to the jamb with the 2x18mm screws. Do not tighten.
- Close the door and adjust the strike up or down until it is central to the handle, then tighten fixing screws.
- Fit the strike cover and secure with the 2 x 11mm screws.

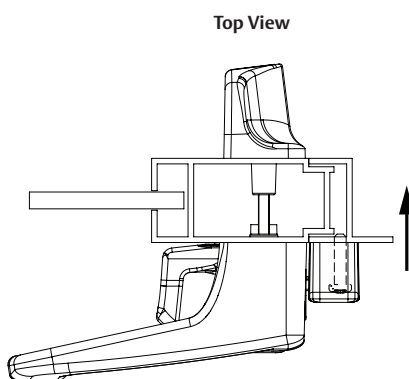

Note: Arrows indicate direction of strike fixing screws

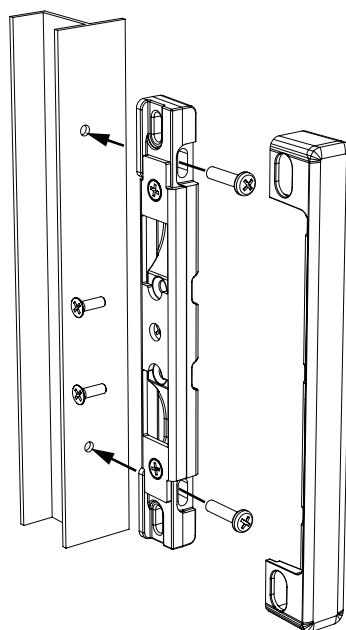

#### Side Fix

- Fit the strike cover and secure with the two M4x11mm screws.
- Fix the strike to the jamb with the 2x18mm screws. Do not tighten.
- Close the door and adjust the strike up or down until it is central to the handle, then open the door and tighten fixing screws.

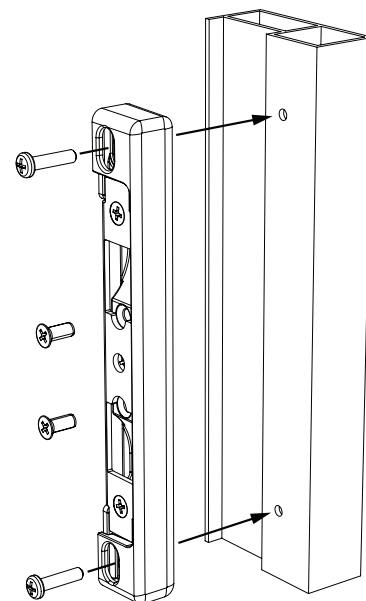
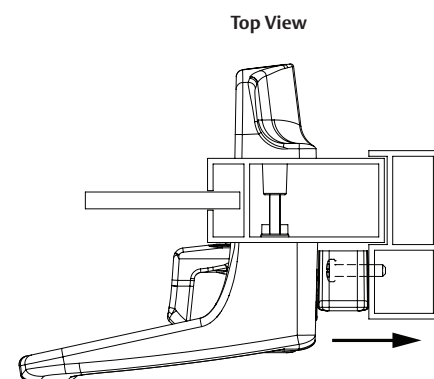

### 8. Check Lock Operation

- Depress the anti-slam pin to check the operation of the lock using both the snib and key-to-lock functions.
- Close the door and ensure that the beaks engage properly with the strike.
- If further adjustment is necessary, partially unscrew the strike plate fixing screws. Adjust the jacking screw height as required and re-tighten the strike plate fixing screws.

Note: Maximum adjustment is 4mm. Do not exceed this as it may compromise security.

