

USER GUIDE

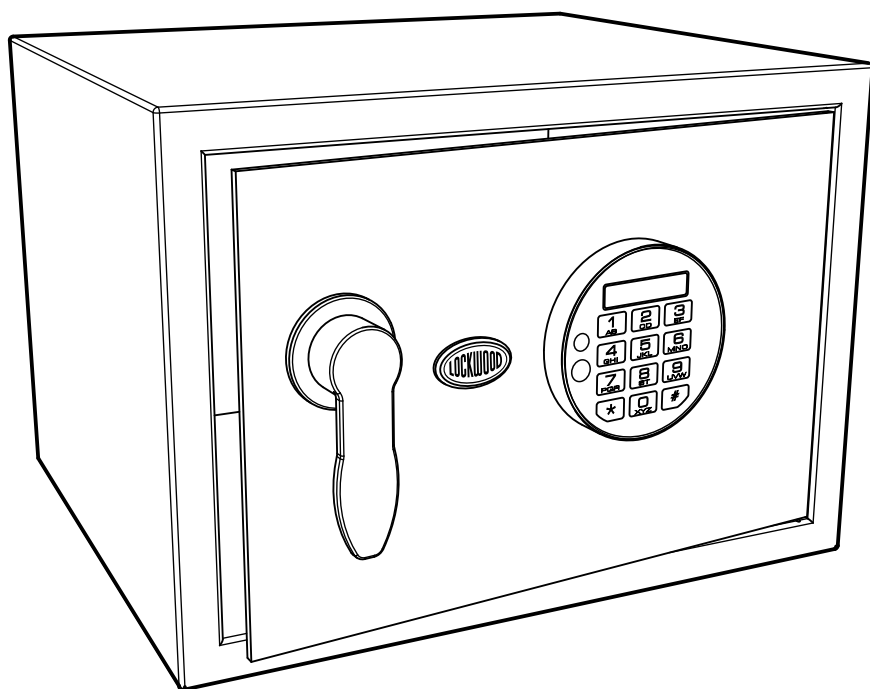

LOCKWOOD DIGITAL HOME SAFE

Introduction

Thank you for purchasing a Lockwood Digital Home Safe.

The Lockwood Safe Range was designed by combining the latest technology and materials, as well as being good looking, easy to use and offering protection for your valuables.

Opening the safe for the first time

- Move the KEY HOLE COVER in anti-clockwise direction.
- Insert the key into the lock and rotate it clockwise.
- Turn the HANDLE in an anti-clockwise direction to open the door.

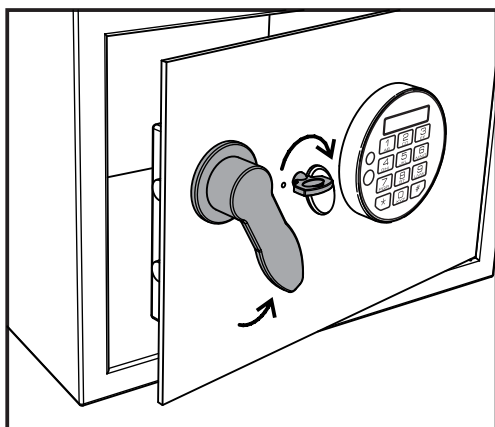
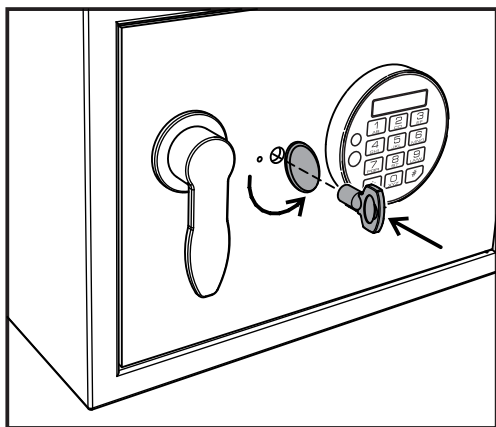

Installing the batteries

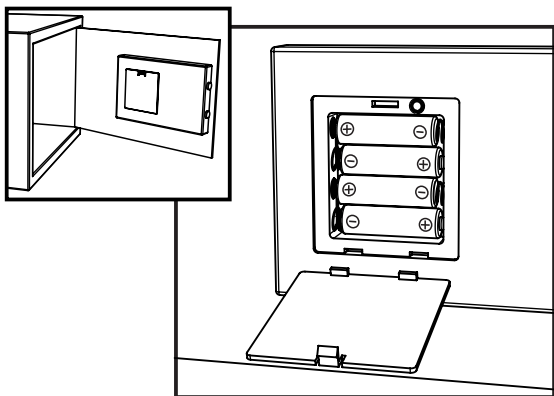

The safe requires 4 × size 'AA' (1.5V) batteries. Remove the battery cover and install the batteries into the compartment. Ensure the batteries are fitted with the correct corresponding polarity. The external LCD display will indicate the status of the electronic lock system automatically. When the power-up process is complete the, display will show 'GOOD'.

Use of good quality batteries is recommend.

Opening the safe

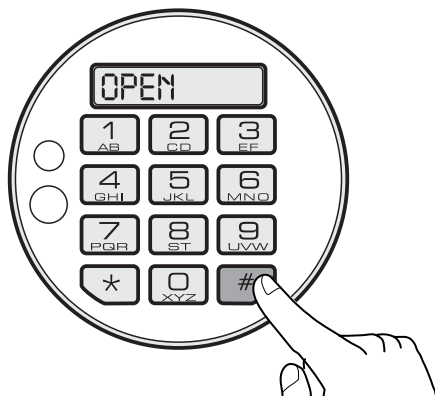
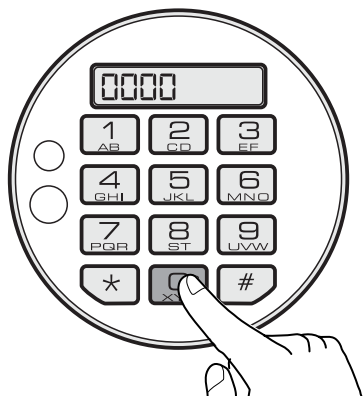

- Input one of the factory preset codes: 0000(user code) or 8888(master code).
- Press # , the display will then show the word 'OPEN'.
- Turn the handle anti-clockwise within 4 seconds of entering the code to unlock the door, .
NOTE: Pressing the '*' button will delete the last digit of the entered code

Warning:

- If the entered code is incorrect, you will hear 3 short beeps and the display will show the word 'ERROR'.
- If the wrong code is entered more than 4 times the keypad will be locked out and the buzzer will sound for 3 minutes. Once this time has lapsed the keypad will allow codes to be re-entered.

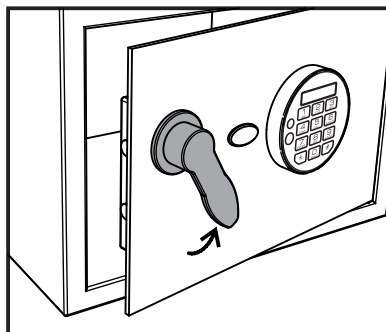

Please note: Digital display lettering may vary depending on safe model.

Programming the code

The safe is programmed with two sets of codes. For your safety, after installing the batteries, you should program two sets of your new codes to replace the factory preset codes.

Programming the User Code

- Press the **SET** button under the battery compartment cover, the display will show 'SET CODE'.
- Input your new user code (3-8 digits).
- Press **#** to confirm. The display will show 'IN'.

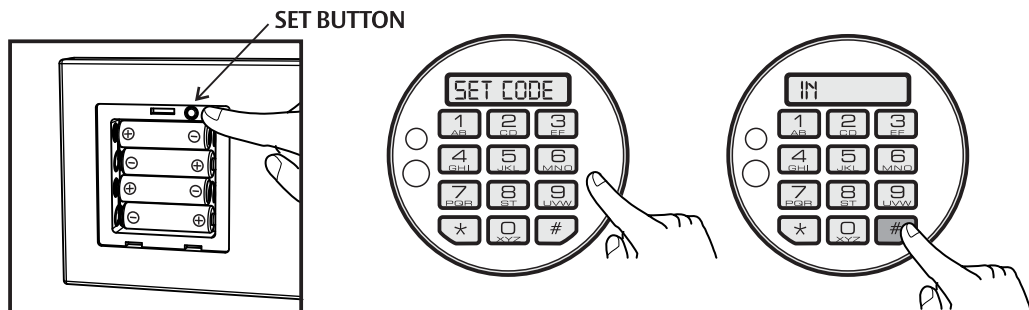

Programming the Master Code

- Press the **SET** button.
- Press **#**. The display will show 'OLD CODE'.
- Input the old master code (Factory preset code 8888), Press **#** to confirm, the display will now show 'SET'.
- Input your new master code, press **#** to confirm. Repeat the code you just entered, the display will show 'REPEAT'. Re-enter your code and press **#** to confirm, the display will show 'IN'.

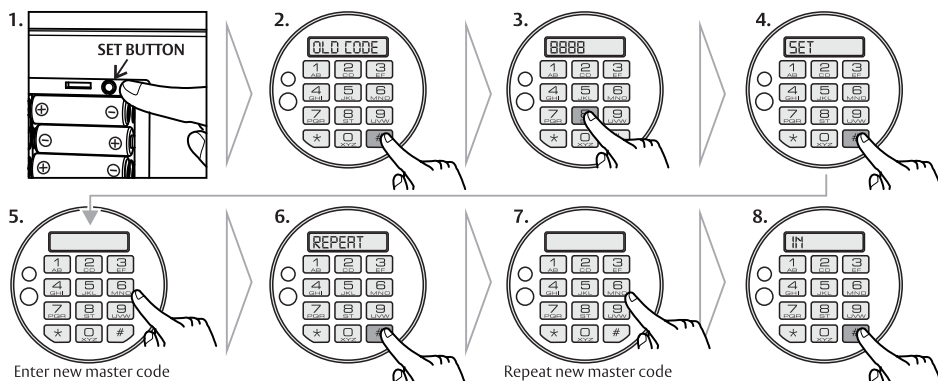

Note:

- If the repeated code does not match the first entered code when programming the master code there will be 3 short beeps and the display will show the word **ERROR**. If this occurs you will need to re-enter the codes
- TEST ALL CODES WITH THE DOOR OPEN TO ENSURE THEY WORK CORRECTLY BEFORE CLOSING THE DOOR**

Buzzer control

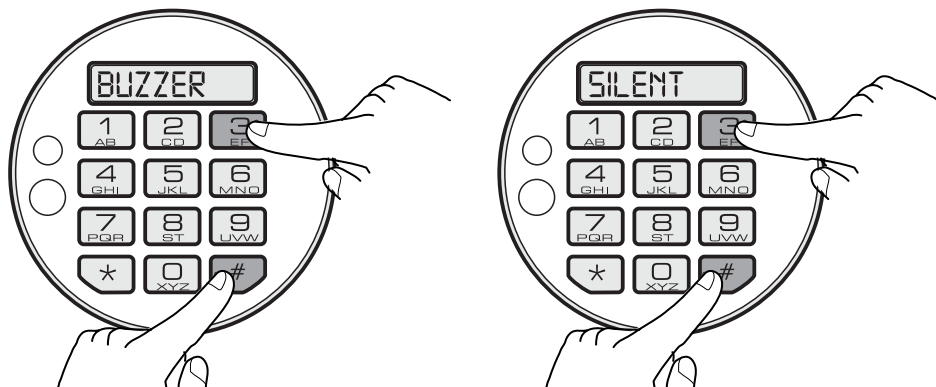

By pressing # and 3 simultaneously, you can control the buzzer sound.

When the display shows 'BUZZER', this means the buzzer will be audible. When the display shows 'SILENT', operation of the keypad will be silent, only warning buzzers will be audible when this function is activated.

Code display control

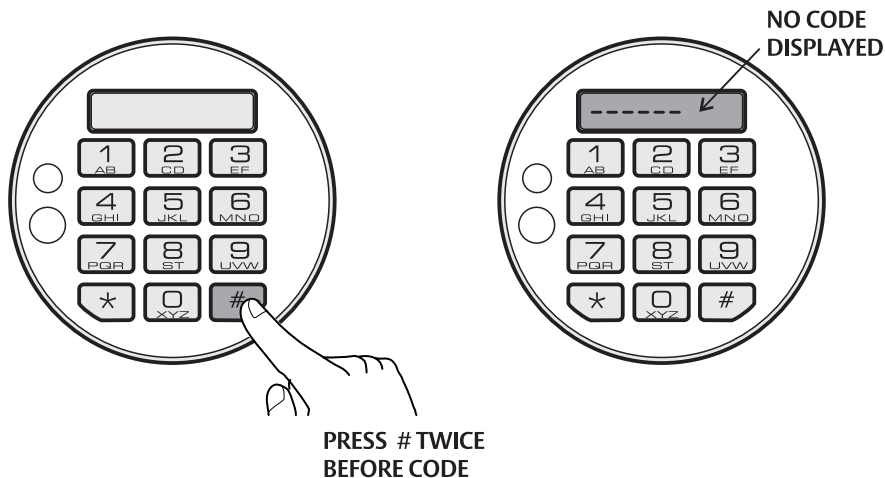

Before inputting the code, press # twice. The input code digits will not be displayed.

Override key function

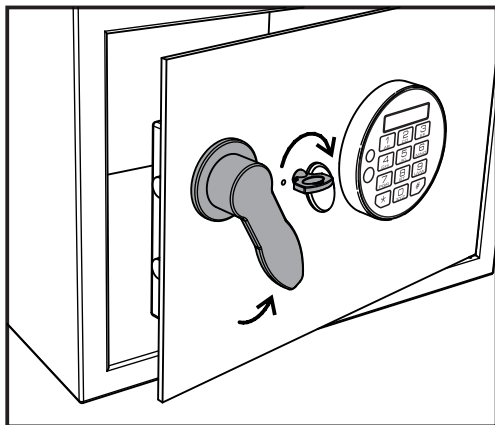
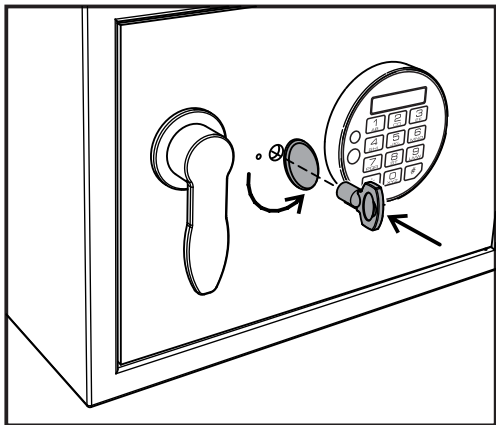

This safe has a manual override system operated by the keys supplied.

- Move the KEY HOLE COVER in anti-clockwise direction.
- Insert the key into the lock and rotate it clockwise.
- Turn the HANDLE in an anti-clockwise direction to open the door.

Warning: Do not store the keys inside the safe. If both keys are misplaced, refer to www.lockweb.com.au for further details.

Battery condition

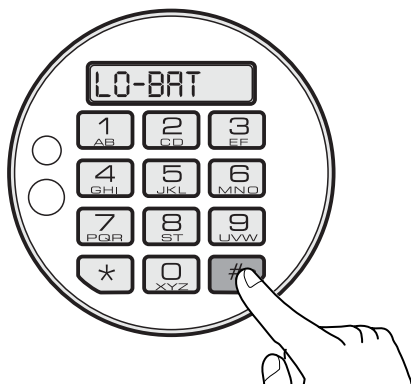

To test the batteries: Press #, if the batteries are low, the display will show 'LO-BAT'. Old batteries should be replaced. If the batteries are ok, the display will show '-----'.

Low Battery Power

9V BATTERY CONNECTIONS

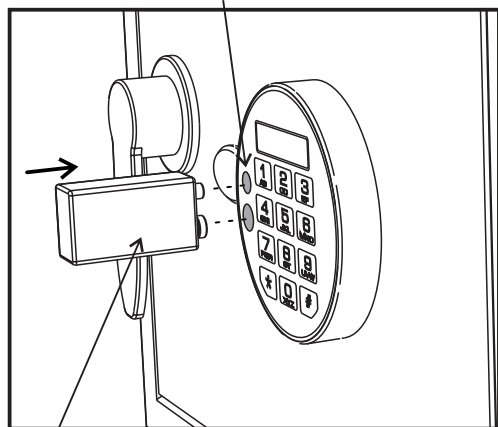

9V BATTERY

In the case that the 4 AA batteries are completely discharged, a 9V battery can be used to supply power to the lock.

9V battery connections are located on the front left hand side of the keypad.

While connecting the 9V battery, the lock can be operated as normal, the 4 AA batteries can then be replaced.

Discharged batteries should be replaced immediately.

Replacing the batteries

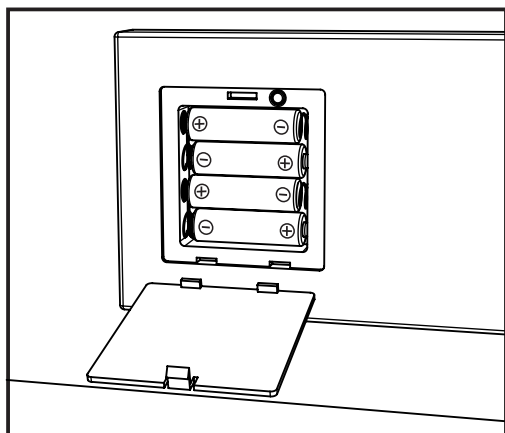

The safe requires 4 × size 'AA' (1.5V) batteries.

Open the safe, then open the battery cover. Remove the old batteries and replace with 4 new good quality alkaline batteries.

NOTE: Ensure all of the batteries are replaced at the same time with new batteries.

DO NOT replace with old, used or mixed batteries.

ASSA ABLOY is the global leader in door opening solutions, dedicated to satisfying end-user needs for security, safety and convenience



Lockwood is the leading brand in the Australian locking industry. With an established reputation for high quality products, this iconic brand provides a wide range of locking solutions to residential housing, commercial building and industrial application markets. Lockwood is supported by an extensive distribution and after-sales support network. Their customers include retailers, architects, trade and industrial personnel, locksmiths and security dealers.

ASSA ABLOY

ASSA ABLOY is the global leader in door opening solutions, dedicated to satisfying end-user needs for security, safety and convenience.

ASSA ABLOY is represented in all major regions, in both mature and emerging markets, with leading positions in Australia, Europe and North America.

As the world's leading lock group, ASSA ABLOY offers a more complete product range of door opening solutions than any other company on the market.

1300 LOCK UP (1300 562 587)
lockweb.com.au